



## HIGH VOLTAGE FUSES MOTOR CIRCUIT PROTECTION – BRITISH STANDARD

Size  
**TA 4**

Rated voltage  
**AC 7.2 kV**

Standard  
**BS 2692-1 · IEC 60282-1 · IEC 60644**

Rated current A	Part No.	Breaking current kA	Weight (kg/1)	Pack
50	30 271 56	50	4.2	1
63	30 271 56	50	4.2	1
80	30 271 56	50	4.2	1
100	30 271 56	50	4.2	1
125	30 271 56	50	4.2	1
160	30 271 56	50	4.2	1
200	30 271 56	50	4.2	1
224	30 271 56	50	4.2	1
250	30 271 56	50	4.2	1
315	30 271 56	50	4.2	1

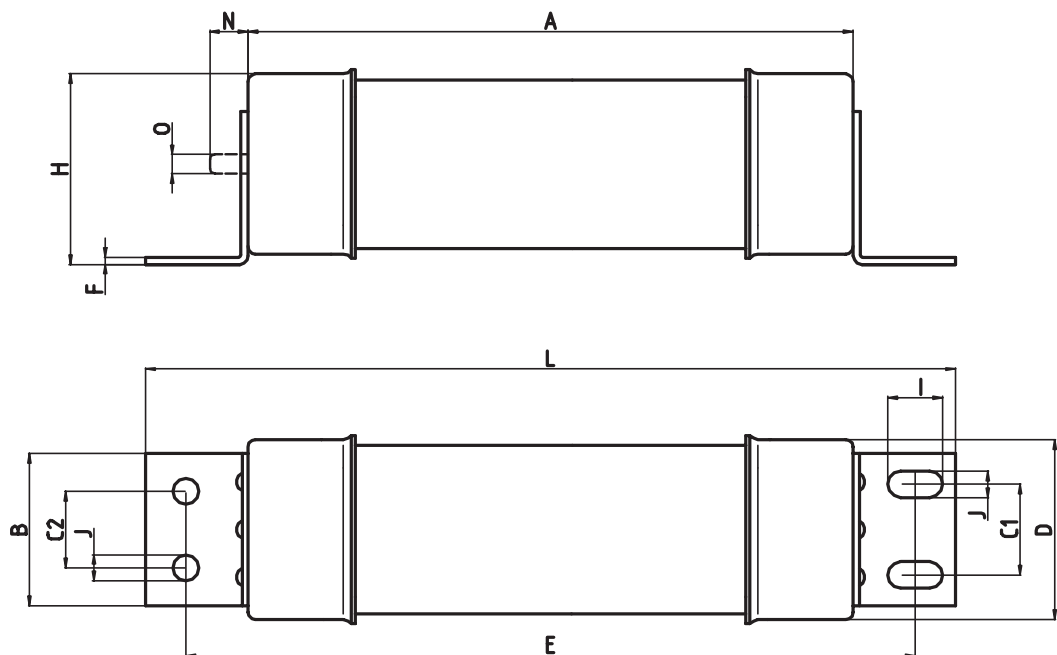

A	15.87" (403 mm)
B	2.56" (65 mm)
C1	1.50" (38 mm)
C2	1.26" (32 mm)
D	3.00" (76 mm)
E	17.87" (454 mm)
F	0.12" (3 mm)
H	3.10" (79 mm)
I	0.90" (23 mm)
J	0.43" (11 mm)
L	19.13" (486 mm)
N	0.50" (13 mm)
O	0.31" (8 mm)

Size **TA 2**      Rated voltage **AC 3.6 kV**      Class **Back up**

Rated current A	Part No.	Breaking current kA	Pre-arcing I <sup>2</sup> t-value A <sup>2</sup> s	Total I <sup>2</sup> t-value A <sup>2</sup> s	Power loss W
50	30 269 56	50	2,400	9,600	23
63	30 269 56	50	3,800	14,800	31
80	30 269 56	50	6,100	22,800	36
100	30 269 56	50	13,000	48,000	39
125	30 269 56	50	23,000	83,000	44
160	30 269 56	50	65,000	220,000	46
200	30 269 56	50	119,000	382,000	54
224	30 269 56	50	139,000	423,000	57
250	30 269 56	50	290,000	826,000	61
315	30 269 56	50	545,000	1,450,000	70

Size **TA 4**      Rated voltage **AC 7.2 kV**      Class **Back up**

Rated current A	Part No.	Breaking current kA	Pre-arcing I <sup>2</sup> t-value A <sup>2</sup> s	Total I <sup>2</sup> t-value A <sup>2</sup> s	Power loss W
50	30 271 56	50	2,400	10,500	34
63	30 271 56	50	3,800	16,500	47
80	30 271 56	50	6,100	25,500	56
100	30 271 56	50	13,000	54,000	60
125	30 271 56	50	23,000	92,500	68
160	30 271 56	50	65,000	247,000	71
200	30 271 56	50	119,000	428,000	83
224	30 271 56	50	139,000	475,000	88
250	30 271 56	50	290,000	928,000	92
315	30 271 56	50	545,000	1,610,000	107

**TIME CURRENT CHARACTERISTICS AND CUT OFF CURRENT DIAGRAM  
PLEASE REFER TO PAGES HHM 8 AND HHM 9**

**Time Current Characteristics**

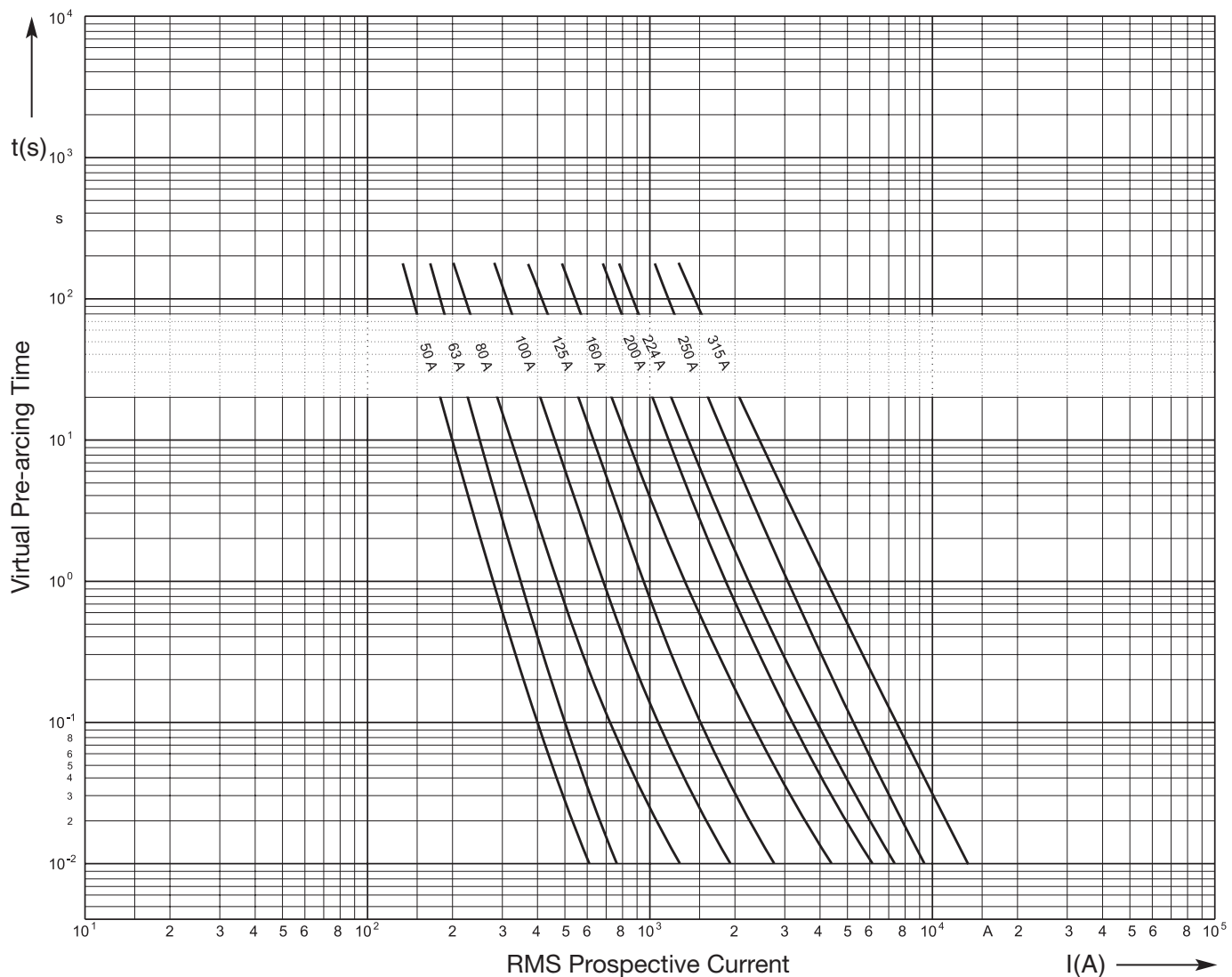

**Cut Off Current Diagram**

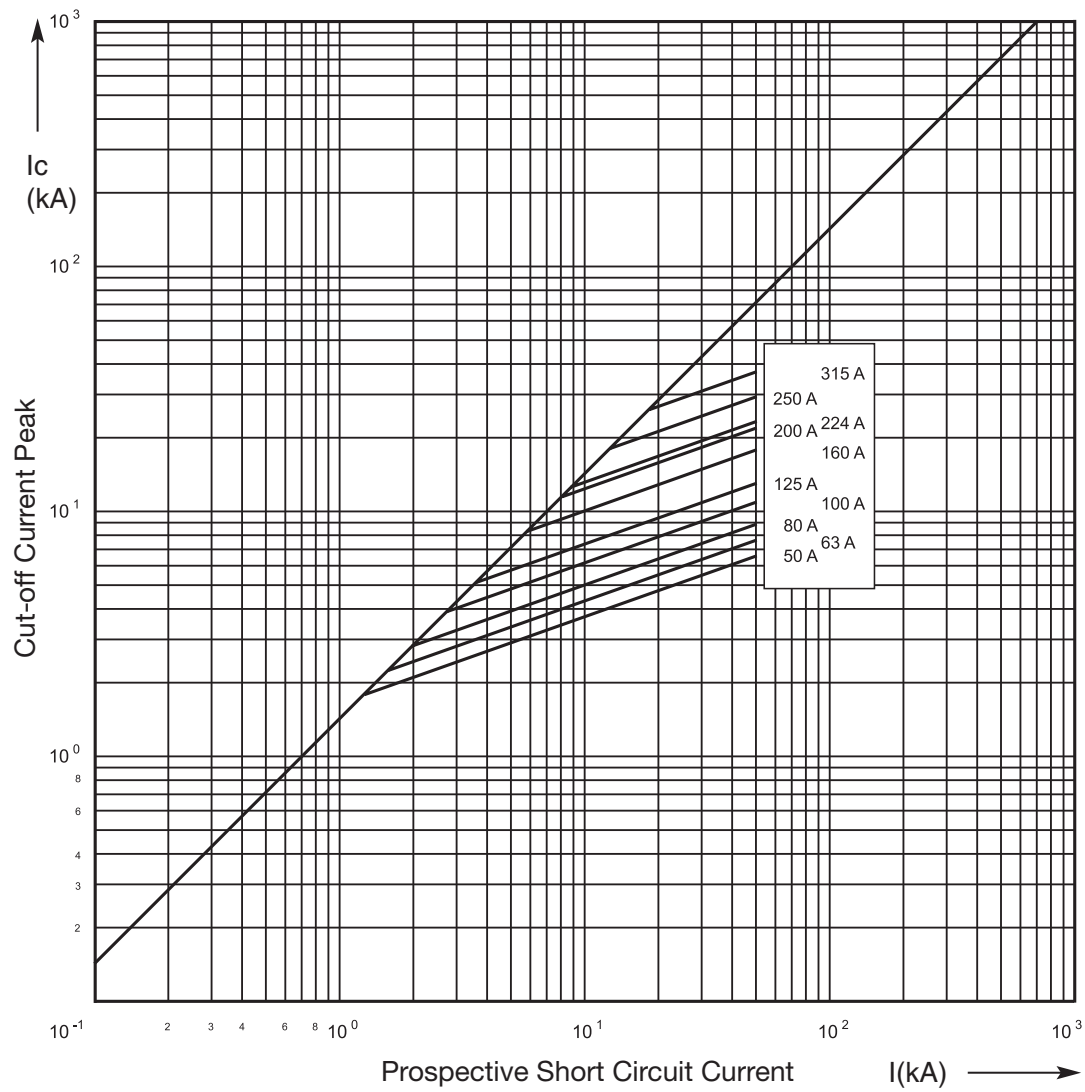

Recommendation

Motor Circuit Application

6 sec

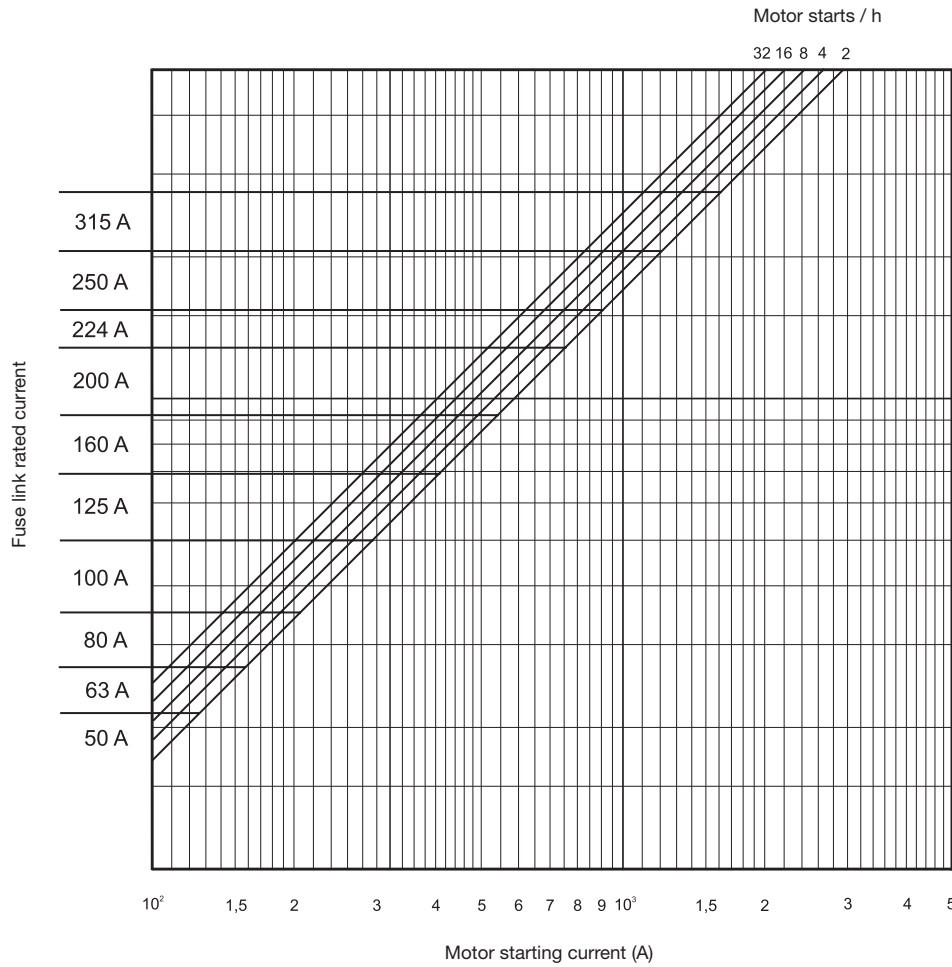

Fuse selection for motors with a run up time not exceeding **6 seconds**; e.g. Pump motors.

Two immediate successive starts are admissible.

**Recommendation                      Motor Circuit Application                      15 sec**

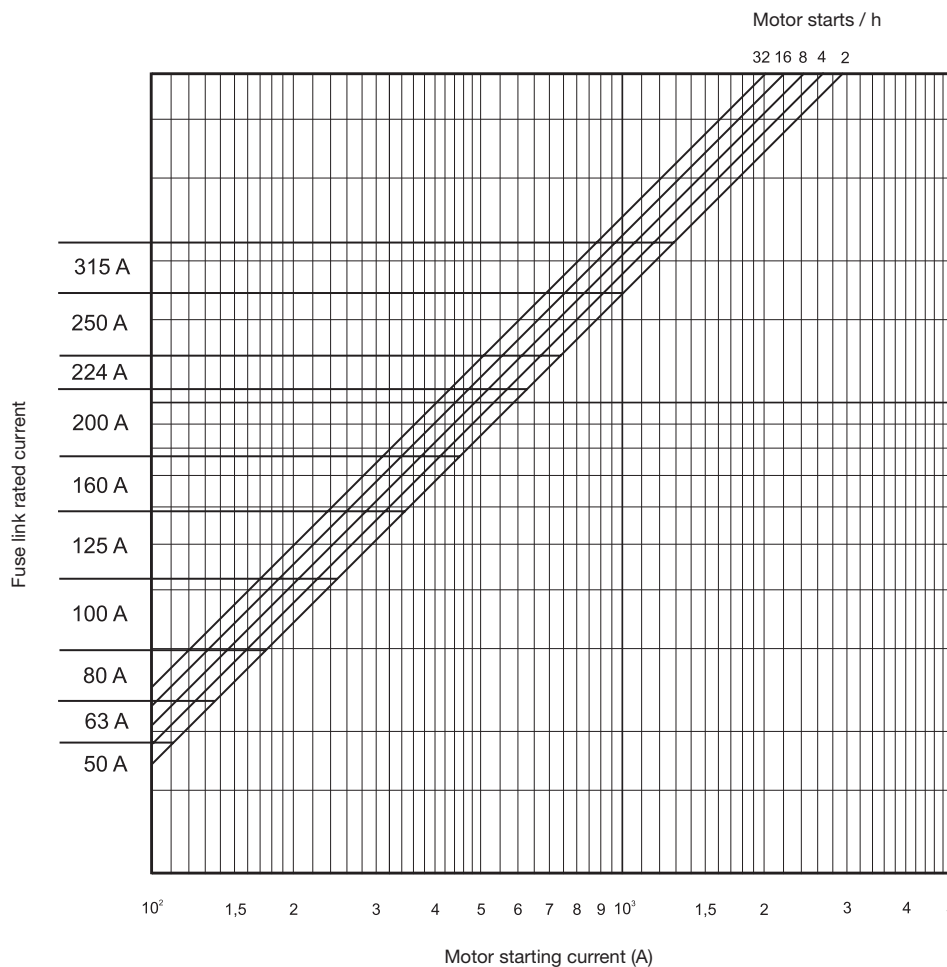

Fuse selection for motors with a run up time not exceeding **15 seconds**; e.g. Fan motors.

Two immediate successive starts are admissible.

**Recommendation**

**Motor Circuit Application**

**30 sec**

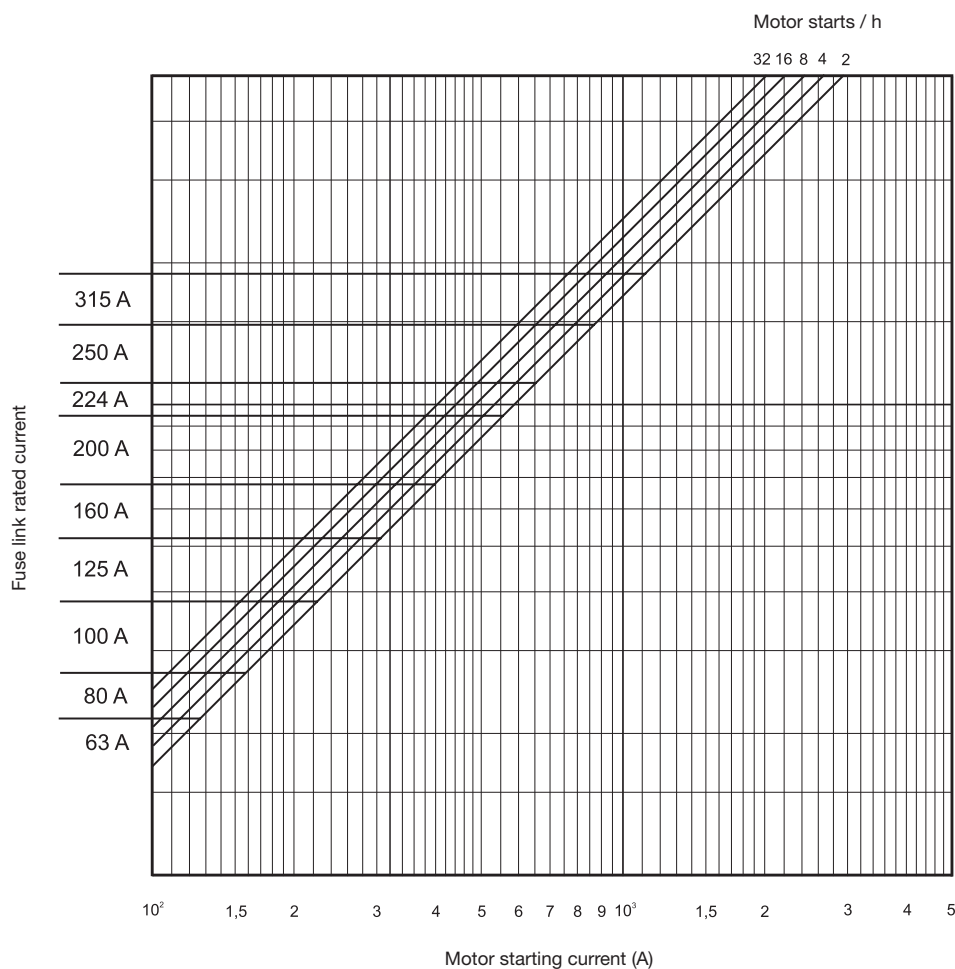

Fuse selection for motors with a run up time not exceeding **30 seconds**; e.g. Mill motors.

Two immediate successive starts are admissible.