

SLP-PV500

Ordering number 8595090536642

SPD PV type 2 - Surge Arrester for PV systems

replaceable module, visual fault signalling, blocking module

For installation in the DC circuits of solar photovoltaic systems. Remote status signaling (S). Maximum continuous operating voltage for PV application: $U_{cpv} \geq 1,2x U_{OC\ STC}$.



Dimension drawing

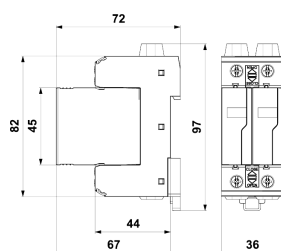

Basic circuit diagram

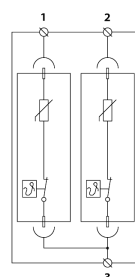

Parameters

Type of SPD		PV T2
Maximum operating voltage mode 1/2	U_{CPV}	750 V DC
Maximum operating voltage mode 1/3, 2/3	U_{CPV}	510 V DC
Nominal discharge current (8/20 μ s)	I_n	15,00 kA
Maximum discharge current (8/20 μ s)	I_{max}	30,00 kA
Voltage protection level mode 1/2	U_p	4,00 kV
Voltage protection level mode 1/3, 2/3	U_p	2,00 kV
Short-circuit current rating	I_{SCPV}	63 A DC
Response time	t_a	25 ns
Cross-section of connected conductors solid - min		1,00 mm ²
Cross-section of connected conductors solid - max		35,00 mm ²
Cross-section of connected conductors stranded - min		1,00 mm ²
Cross-section of connected conductors stranded - max		25,00 mm ²
Fault indication		red indication field
Degree of protection		IP 20
Range of operating temperatures - min		-40 °C
Range of operating temperatures - max		80 °C
Mounting		DIN rail 35 mm
According to standard		EN 50539-11:2013
Plug module		SLP-PV500U V/0
ETIM Class		EC000941